

Components for BZC8050 Control Stations BD8060 Series Indicators



- ◆ Explosion protection to
 - CENELEC
 - IEC
 - NEC
- ◆ Can be used in
 - Zone 1 and Zone 2
 - Zone 21 and Zone 22
 - Class I, Zone 1 and Zone 2
 - Class I, Division 2, Groups A, B, C, D
- ◆ Available in
 - red
 - green
 - yellow
 - blue
 - white
- ◆ Two mounting types
 - cover mounting
 - rail mounting
- ◆ Two-wire interface, can be paralleled, the maximum wire diameter is 2.5mm².
- ◆ High power, high brightness, even and harmonious.

■ Catalogue number logic

BD8060(D for short)

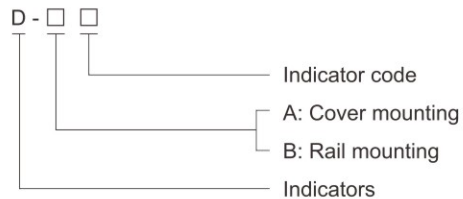

Zones 1&2; 21&22

Components for BZC8050 Control Stations BD8060 Series Indicators

Selection table							
Version	Voltage	Schematic diagram	Colour	Code	Ordering code	Weight (kg)	
 <p>A: Cover mounting</p>	Rated voltage: AC 220V...AC 440V Voltage range: -10%...+6% Frequency: 50Hz...60Hz		Red	Ra	40099C/40099D	0.05	
			Green	Ga	40100C/40100D		
			Yellow	Ya	40101C/40101D		
			Blue	Ba	40166C/40166D		
			White	Wa	40102C/40102D		
	 <p>B: Rail mounting</p>	Rated voltage: AC/DC 48V...125V Voltage range: -10%...+6% Frequency: 0Hz...60Hz		Red	Rb	40103C/40103D	0.05
				Green	Gb	40104C/40104D	
				Yellow	Yb	40105C/40105D	
				Blue	Bb	40167C/40167D	
				White	Wb	40106C/40106D	
	 <p>B: Rail mounting</p>	Rated voltage: AC/DC 12V...36V Voltage range: -10%...+6% Frequency: 0Hz...60Hz		Red	Rc	40107C/40107D	0.05
				Green	Gc	40108C/40108D	
Yellow				Yc	40109C/40109D		
Blue				Bc	40168C/40168D		
 <p>B: Rail mounting</p>		Rated voltage: DC 220V~250V Voltage range: -10%...+6%		Red	Rd	40111C/40111D	0.05
				Green	Gd	40112C/40113D	
				Yellow	Yd	40113C/40113D	
				Blue	Bd	40169C/40169D	
 <p>A: Cover mounting</p>			Red	a	40115A	0.05	
			Green	b	40116A		
			Yellow	c	40117A		
			White	d	40118A		
			Blue	e	40170A		
 <p>B: Rail mounting</p>			Red	a	40115B	0.05	
			Green	b	40116B		
			Yellow	c	40117B		
			White	d	40118B		
			Blue	e	40170B		



Components for BZC8050 Control Stations BD8060 Series Indicators

Technical data	
Indicators	BD8060
Explosion protection	
Global (IECEX)	IECEX CQM 24.0019U
Gas	Ex db eb IIC Gb
Europe (ATEX)	CML 24 ATEX 1227U
Gas	⊕ II 2 G Ex db eb IIC Gb
Certificates	IECEX; ATEX
Conformity to standards	EN 60079-0, EN 60079-1, EN 60079-7 IEC 60079-0, IEC 60079-1, IEC 60079-7
Rated voltage	AC/DC12V~36V, AC/DC48V~125V, DC220V~250V, AC220V~440V
Rated current	Max.15mA
Frequency	0Hz...60Hz
Rated output wattage	Max.3W
Service life	10 ⁵ hours
Ambient temperature	-60°C~+90°C
Colour	Red, green, yellow, blue, white
Lamp	LED
Enclosure material	Polyamide (PA66)
Terminal	Suitable for 2.5mm ² cable
Indicator cover material	PC

Dimension drawings (all dimensions in mm) - subject to alteration

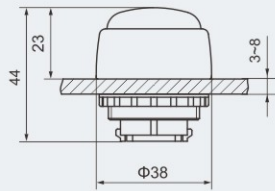

A: Cover mounting

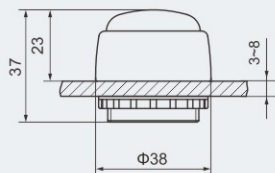

B: Rail mounting
Indicator cover

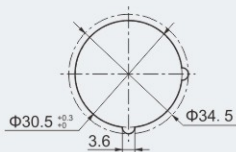

Mounting hole

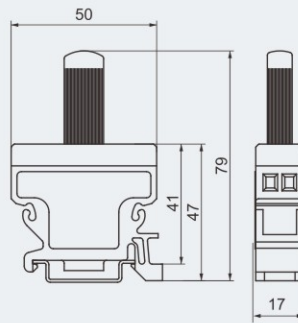

Indicator
(rail mounting)

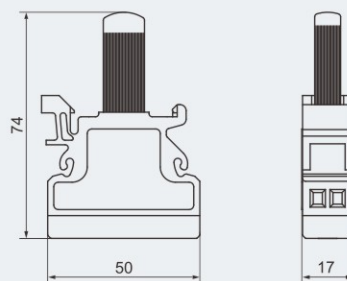

Indicator
(cover mounting)

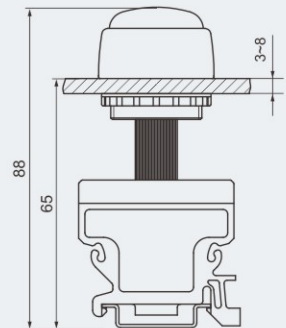

Rail mounting

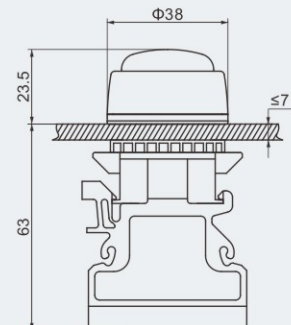

Cover mounting